

ITEM NO.	PART NUMBER	DESCRIPTION	QTY.	REVISIONS			
1	FI .5 x 6 L 8	LENGTH: 8"	1	REV.	DESCRIPTION	DATE	APPROVED
				A	INITIAL RELEASE	6/12/2023	BB

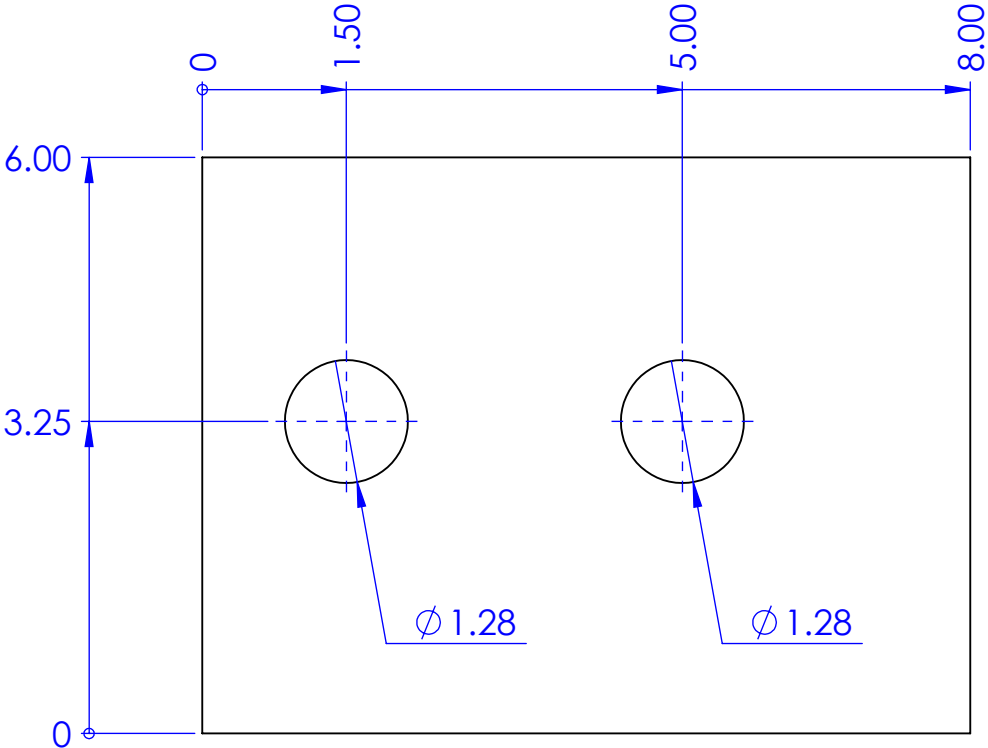

**PROPRIETARY AND CONFIDENTIAL**  
THE INFORMATION CONTAINED IN THIS  
DRAWING IS THE SOLE PROPERTY OF  
HYDRABEDS. ANY REPRODUCTION IN PART  
OR AS A WHOLE WITHOUT THE WRITTEN  
PERMISSION OF HYDRABEDS IS PROHIBITED.

UNLESS OTHERWISE SPECIFIED:  
DIMENSIONS ARE IN INCHES  
TOLERANCES:  
FRACTIONAL  $\pm 1/16$   
ANGULAR: MACH  $\pm 1$  BEND  $\pm 1$   
TWO PLACE DECIMAL  $\pm .010$   
THREE PLACE DECIMAL  $\pm .005$

MATERIAL FI 1/2" x 6"  
DO NOT SCALE DRAWING

	NAME	DATE	P.O. BOX 248, SABETHA, KS 66534 (785) 284-3674 FAX (785) 284-3931	
DRAWN	KADEN	6/12/2023		
PART #	FI .5 x 6 L 8			
ASM #	Asm #			
COMMENTS:			LENGTH: 8"	
SIZE	DWG. NO.		REV	
A	11-2109		A	
SCALE: 1:5	WEIGHT: 6.44		SHEET 1 OF 1	